

## Light Fittings for Fluorescent Lamp

### BnY81-G Series Explosion-proof Light Fittings for Fluorescent Lamp



- ◆ Explosion protection to
  - CENELEC
  - IEC
  - NEC
- ◆ Can be used in
  - Zone 2
  - Zone 21 and Zone 22
  - Class I, Zone 2
  - Class I, Division 2, Groups A, B, C, D
- ◆ Toughened glass transparent cover, high light transmittance, resistance to high energy impact and thermal fusion.
- ◆ Enclosure is formed of stainless steel.
- ◆ Built-in electronic ballast, power factor  $\geq 0.95$ .
- ◆ LED driver, wide voltage input, CC-CV (constant current - constant voltage) output, power factor  $\geq 0.95$ .
- ◆ End of lamp life (EOL) rectification effect protection.
- ◆ Emergency functions is available on request.

#### Catalogue number logic

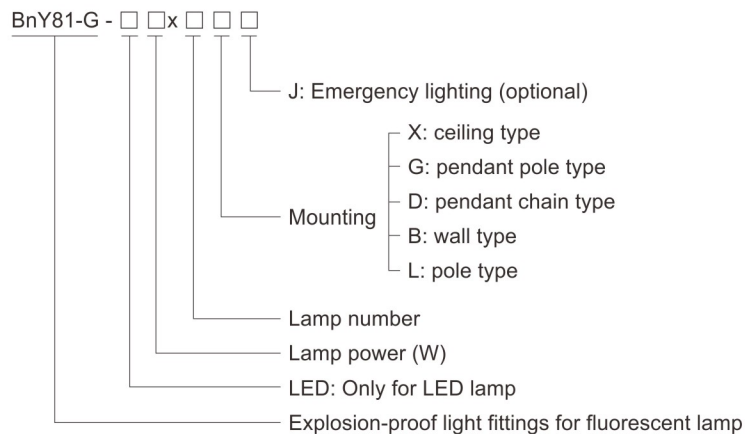

## Zones 2; 21&22

## Light Fittings for Fluorescent Lamp

### BnY81-G Series Explosion-proof Light Fittings for Fluorescent Lamp

#### Technical data

#### Explosion-proof light fittings for fluorescent lamp BnY81-G-□□ × □□□□

##### Explosion protection

Global (IECEX)

Gas and dust

Europe (ATEX)

Gas and dust

IECEX (applied for)

Ex nA IIC T4 Gc

Ex tb IIIC T80°C Db IP66

ATEX (applied for)

Ex II 3 G Ex nA IIC T4 Gc

Ex II 2 D Ex tb IIIC T80°C Db IP66

IECEX; ATEX; Russia (CU-TR)

##### Certificates

##### Conformity to standards

EN 60079-0, EN 60079-15, EN 60079-31

IEC 60079-0, IEC 60079-15, IEC 60079-31

##### Material

Enclosure

Glass cover

Ballast

LED driver

Exposed fastener

Stainless steel

Toughened glass, stands 4J impact

Electronic ballast, power factor ≥ 0.95

Wide voltage input, CC-CV (constant current - constant voltage) output, power factor ≥ 0.95

Stainless steel

##### Lamp

Lamp specification

T8 fluorescent lamp (supplied with the light fittings)

LED module (supplied with the light fittings)

Lamp power (W)

T8: 18Wx2, 36Wx2

LED: 9Wx2, 18Wx2

LED Colour Temperature (CCT)

5000K

Note: nature white is available in general. Warm white or cool white is optional, please specify when ordering.

##### Rated voltage

T8: 100~300V AC 50/60Hz

LED: 110~265V AC 50/60Hz

##### Degree of protection

IP66

##### Ambient temperature

-40°C~+55°C

##### Terminal

3 x 1.5~4mm<sup>2</sup> (L+N+PE)

##### Cable entries

2 x Φ21: 2 x M20 x 1.5 cable glands (DQM-I Ex e, plastic)

##### Available cable outer diameter

Φ6~Φ12 (mm)

##### Emergency data

Emergency unit

Special emergency controller and Ni-MH battery pile, with protection against over-charge and overdischarge

Emergency power (W)

T8: 18W x 1, 36W x 1; LED: 9W x 1, 18W x 1

Emergency starting time

0.3s

Charging time

24h

Emergency lighting time

120min (180min is optional)

#### Selection table

Type / Ordering code	Lamp power(W)	Weight(kg)	Type / Ordering code	Lamp power(W)	Weight(kg)
BnY81-G-18 x 2X	18x2	4.40	BnY81-G-36 x 2X	36x2	7.55
BnY81-G-18 x 2G	18x2	4.60	BnY81-G-36 x 2G	36x2	7.70
BnY81-G-18 x 2D	18x2	4.70	BnY81-G-36 x 2D	36x2	7.85
BnY81-G-18 x 2B	18x2	4.75	BnY81-G-36 x 2B	36x2	7.90
BnY81-G-18 x 2L	18x2	4.40	BnY81-G-36 x 2L	36x2	7.60
BnY81-G-LED 9 x 2X	9x2	4.30	BnY81-G-LED 18 x 2X	18x2	7.45
BnY81-G-LED 9 x 2G	9x2	4.45	BnY81-G-LED 18 x 2G	18x2	7.65
BnY81-G-LED 9 x 2D	9x2	4.60	BnY81-G-LED 18 x 2D	18x2	7.76
BnY81-G-LED 9 x 2B	9x2	4.65	BnY81-G-LED 18 x 2B	18x2	7.80
BnY81-G-LED 9 x 2L	9x2	4.30	BnY81-G-LED 18 x 2L	18x2	7.50

**Note:** 1. Products above include all the mounting accessories listed in Mounting Accessories & Spare Parts Table (see P2/47).



## Light Fittings for Fluorescent Lamp

### BnY81-G Series Explosion-proof Light Fittings for Fluorescent Lamp

**Photometric data** Note: LED luminous flux is from the standard product of which colour temperature is 5000K

BnY81-G-□□ x 2□□

Rated luminous flux  
T8: 18Wx2: 2600lm

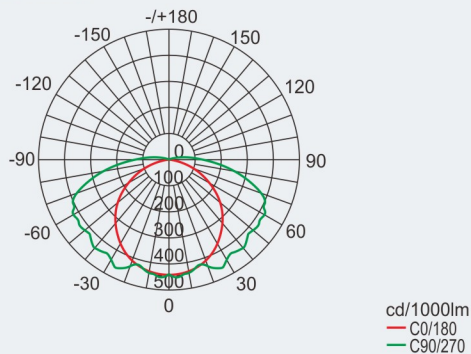

BnY81-G-□□ x 2□□

Rated luminous flux  
LED: 9Wx2: 2160lm

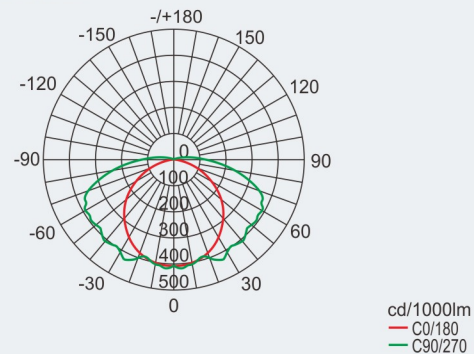

BnY81-G-□□ x 2□□

Rated luminous flux  
T8: 36Wx2: 6500lm

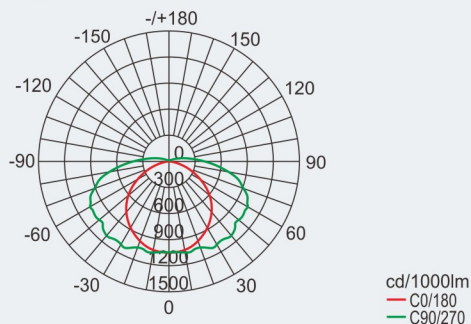

BnY81-G-□□ x 2□□

Rated luminous flux  
LED: 18Wx2: 4320lm

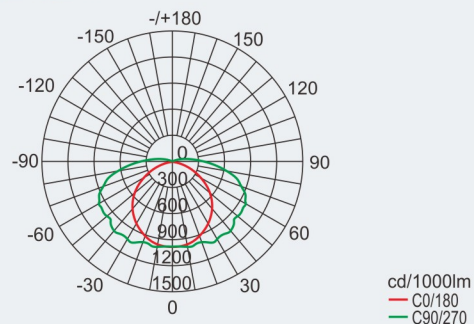

We can provide lighting design and data by professional lighting software DIALUX based upon simulated site situation on request.

#### Dimension drawings (all dimensions in mm) - subject to alteration

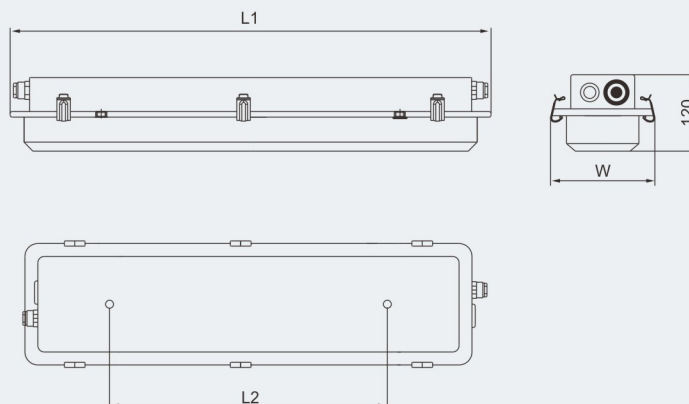

Type / Ordering code	L1	L2	W
BnY81-G-18x2□, BnY81-G-LED 9x2□	692	430	150
BnY81-G-36x2□, BnY81-G-LED 18x2□	1300	950	150

## Light Fittings for Fluorescent Lamp

### BnY81-G Series Explosion-proof Light Fittings for Fluorescent Lamp

#### Mounting type (all dimensions in mm) - subject to alteration

Installation reference

D: pendant chain type

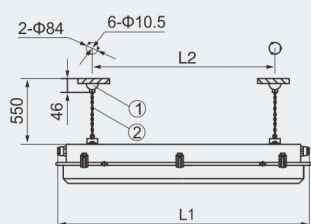

G: pendant pole type

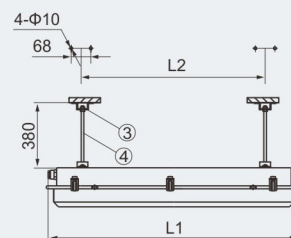

X: ceiling type

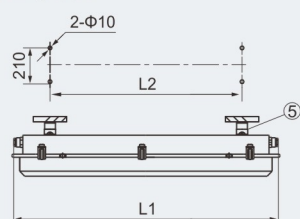

B: wall type

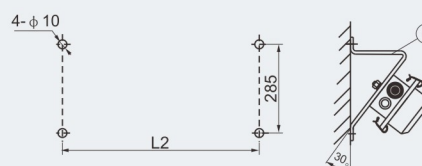

L: pole type (the pole is provided by user)

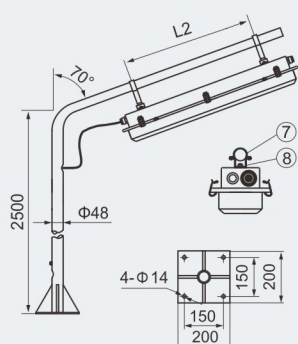

Suitable for ground pole type

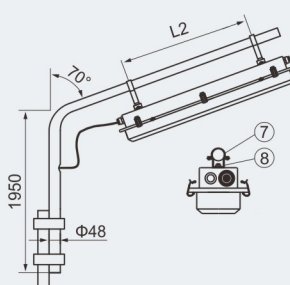

Suitable for fence pole type

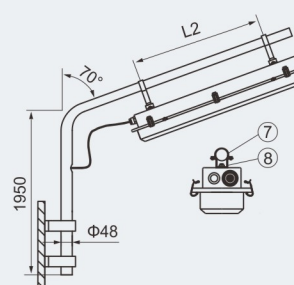

Suitable for wall pole type



#### Mounting Accessories & Spare Parts Table

Supplied according to the mounting type

Mounting type	Accessories			Ordering code	Weight (kg)
	Name	Qty	Illustration		
D: pendant chain type	①.Sucker	2	See P2/6	5136017	0.15
	②.Chain	2	Length: 450mm	5136016	0.08
G: pendant pole type	③.Mounting bracket	2	Stainless steel, see P2/6	51S01G1	0.04
	④.M8 Screw	2	Stainless steel, length: 350mm	51S01G2	0.12
X: ceiling type	⑤.Mounting bracket	2	Stainless steel, see P2/7	5136015	0.20
B: wall type	⑥.Wall bracket	2	Stainless steel, welded sheet steel	5236B02	0.25
L: pole type	⑦.G1 1/2" Pipe clamp	2	Stainless steel, see P2/7	5136014	0.04
	⑧.Mounting bracket	2	Stainless steel, see P2/7	5136012	0.04

**Note:** Accessories not in the table shall be supplied by user.